

# Knole

## Access Guide

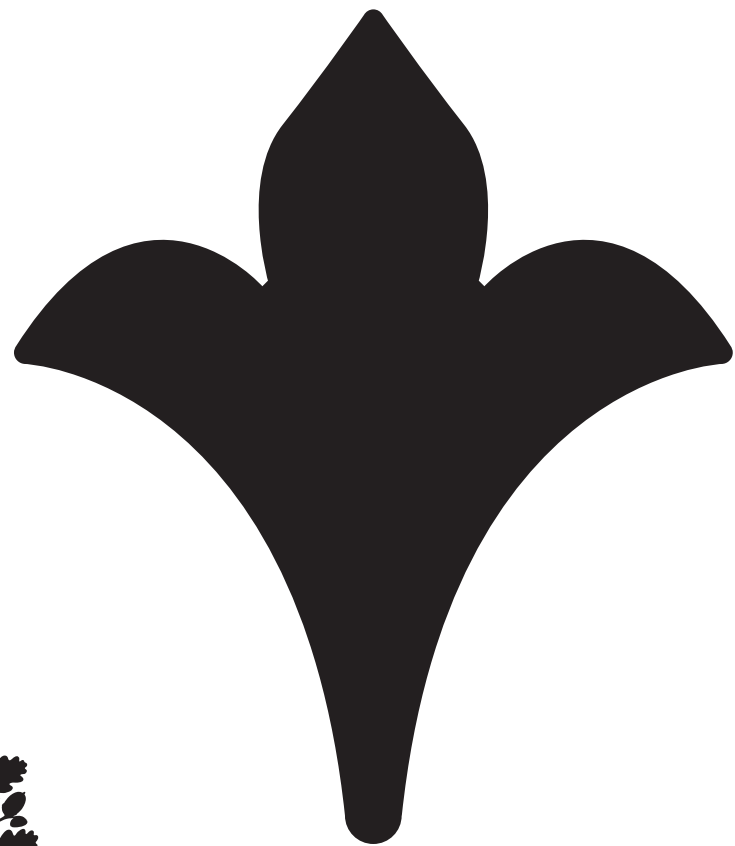

## Welcome to Knole

Knole is committed to making its heritage as accessible as possible and this guide has been designed to help visitors make the most of their visit. If there is additional information that you would like us to include in future versions of this guide, please email [knole@nationaltrust.org.uk](mailto:knole@nationaltrust.org.uk)

## Courtyard areas to visit

### Visitor Centre

The Visitor Centre provides the perfect introduction to Knole's long and intricate history.

### Estate Office

Listen to oral history interviews in the old Knole Estate Office. Discover a world of 1940s administration with rotary telephones, manual adding machines and vintage typewriters.

### Bookshop Café

Browse our selection of books or pick up a gift for a friend. Relax in the bookshop's café with a drink and snack.

### Orangery

Built in the early 19th century, the Orangery is one of Knole's brightest, most ethereal spaces.

## Access to the Showrooms

Wheelchairs are restricted to the Great Hall and the bottom of the Great Staircase.

- The floor levels change throughout the first floor and there are a number of steps to negotiate
- Wheelchairs and pushchairs do not fit through all of the doorways
- Some of the Showrooms are very small and narrow and the use of wheelchairs and pushchairs would cause congestion
- Emergency evacuation routes throughout the building are narrow and steep, making it impossible to evacuate visitors in wheelchairs and pushchairs quickly and safely

Knole is a Grade I listed building, which greatly restricts the amount of adjustments we are able to make.

Pushchairs may be left by the entrance to the Showrooms in Stone Court. Large bags and valuables can be locked away – please ask room guides in the Great Hall for assistance.

## Charging for admission

Carers go free with each paying disabled visitor. No charge is made for visitors who are unable to go beyond the Great Staircase.

If the carer plans on visiting the Showrooms independently a charge will be made for entrance.

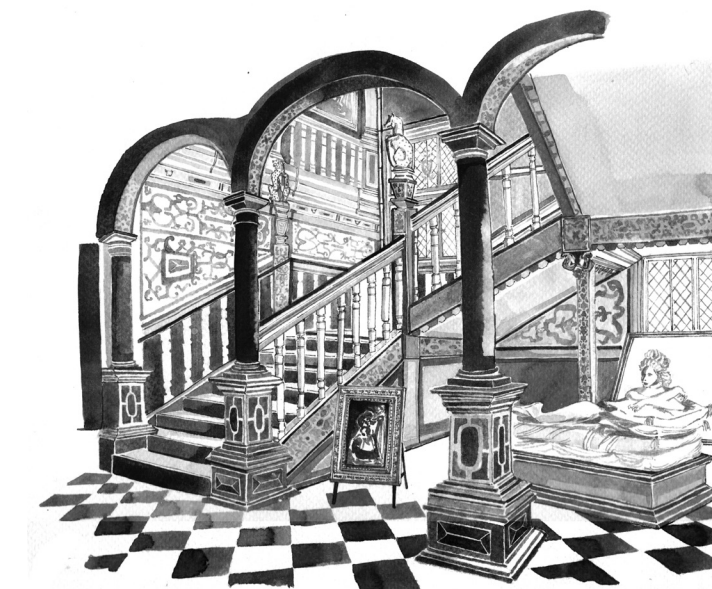

Get in touch on 01732 462100 or by emailing [knole@nationaltrust.org.uk](mailto:knole@nationaltrust.org.uk)

The National Trust is a registered charity no. 205846  
© National Trust 2015

Design Hyperkit Illustrations © Emily Robertson

## Knole easy reference access guide

- 1 Great Hall**  
Room describer tours for visually impaired visitors — please phone beforehand or discuss your needs with staff in the Visitor Centre
- Braille and large print guides
- Easy Read guide for visitors with learning difficulties
- Gloves and touch list for visitors with learning difficulties
- Free entry to visitors using wheelchairs on the ground floor only
- 2 Stone Court**  
Wheelchair ramp to entrance to Showrooms

- 3 Green Court**  
Accessible toilet at main entrance
- 4 Visitor Centre**  
Wheelchair for visitors to borrow
- Tactile ceramic model of the house
- iPads with a variety of films covering Knole's conservation and history
- 5 Bookshop Café**  
Hearing Loop
- Lift into the Orangery from the bookshop

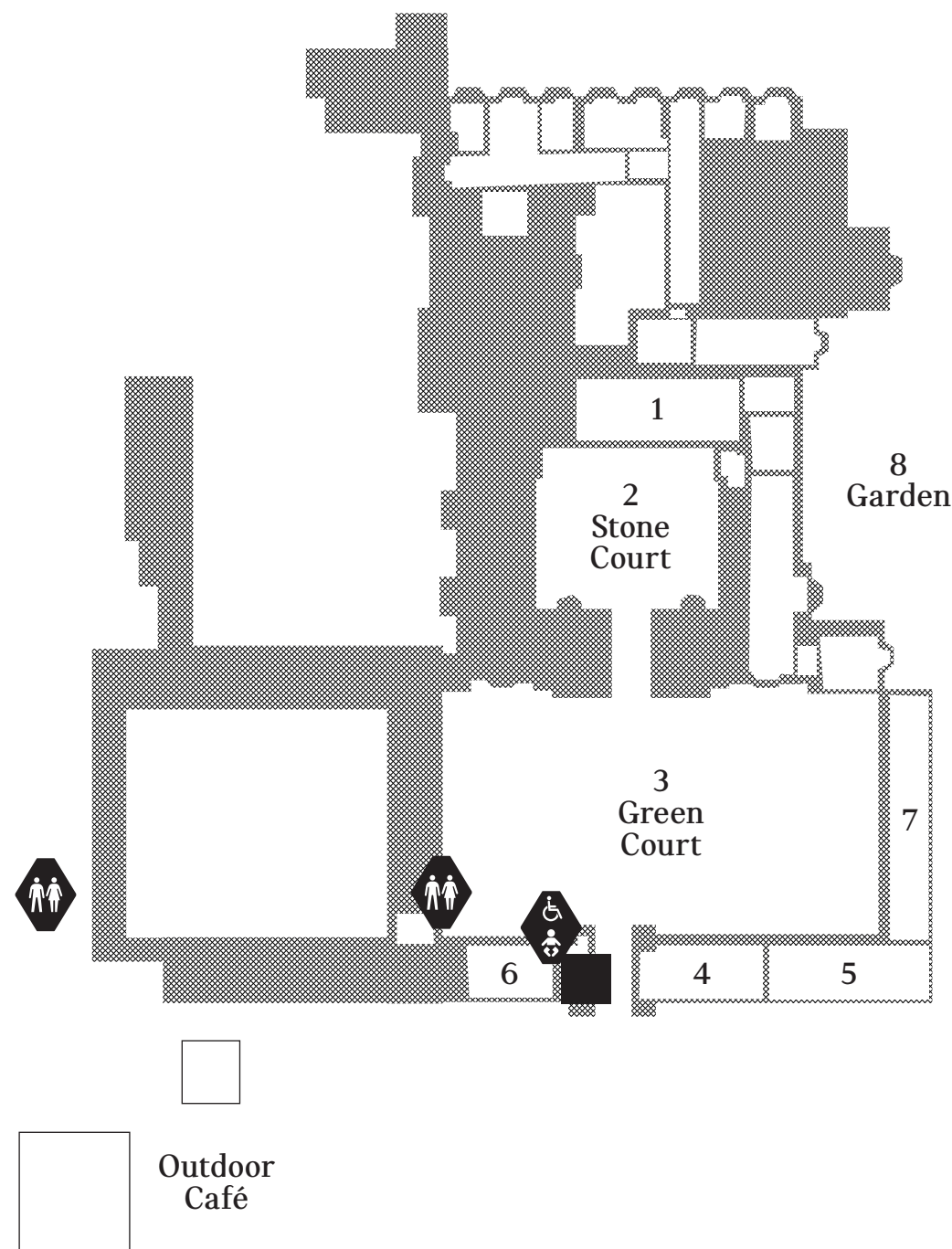

- 6 Estate Office**  
Ramp into Estate Office — request assistance from the Visitor Centre

Transcripts of interviews in Estate Office

- 7 Orangery**  
Lift into the Orangery from the Bookshop Café

- 8 Garden**  
Lip spoken tours — see events programme on website or ask at the Visitor Centre

Map with suggested route for wheelchairs

- Park**  
Guided wheelchair walks available — booking required

Mobility scooter available for hire, this must be prebooked — please ask in the Visitor Centre



## Preserving Knole for future generations

Knole's fading beauty continues to draw admirers. Although time has taken its toll on the fabulous treasures, we're now working to slow the decline. With funding from the Heritage Lottery Fund and individuals, we've begun a five-year programme to preserve Knole for future generations.

2016 will be unlike any other year at Knole, as we open never before seen spaces to visitors. This includes the Knole Conservation Studio, Hayloft Learning Centre, the Gatehouse Tower and refurbished Brewhouse Café.

