

Gunby Estate, Hall and Gardens Access Statement

Gunby, Spilsby
PE23 5SS
T: 01754 890102
E: gunbyhall@nationaltrust.org.uk

Introduction

- Gunby Estate, Hall and Gardens consists of a 42 room William and Mary house set over four floors, an eight acre garden on level ground and 1500 acre grounds which has some undulation and is mostly tenanted farmland.
- Mobile reception is patchy, with Vodafone and BT/EE offering the best coverage. There is no 3G anywhere on site, but the cottage in the grounds is a BT hotspot with a reasonable range. The number to call in case of an emergency is 01754 890102.
- Well behaved dogs on leads are welcome anywhere in the grounds and gardens. Assistance dogs are welcome in the house too.
- Entrance and exit to the house is via steps. There is a wheelchair and a wheeled walker with seat available for use on the ground floor of the house. These can be booked in advance or used ad-hoc subject to availability.

Arrival & Parking Facilities

- Gunby can be hard to find as our postcode may misdirect satnavs but there are brown signs. Gunby is located on the A158 (5 miles from Skegness) off the Gunby roundabout.
- There are ample disabled parking spaces a few metres from the property entrance.
- All parking is on grass with no marked bays.
- There is no transfer vehicle for wheelchair users.
- If the designated car park is full, visitors can be dropped off near the property entrance.
- On event days we use overflow parking in the farmland in front and adjacent to the house.

WCs – situated in the courtyard opposite the entrance point

- There is a partly modified unisex toilet for wheelchair users.
- The accessible toilet is 220cm x 138cm.
- The accessible WC is right hand transfer and the door width is 81cm.
- There is muted natural light from a small window.
- The toilets have automatic hand dryers and fluorescent lighting.
- There is no Changing Places facility.



Visitor Reception

- The visitor reception has a concrete floor inside and uneven cobbles outside.
- There is a small step/ledge into the tea-room (2cm deep) but when admissions is located outside there is no step.
- The entrance door is 239cm wide.
- The entrance doors are permanently wide open and secured open by hooks.

- The height of the counter in the tea-room is 92cm high, and the temporary counter that is often used outside is 107cm high, but staff and volunteers move around the counter to serve and assist visitors, and there are clip boards available to lean on to complete 'Gift Aid on Entry' cards.
- There is ample natural light and some electric light.
- There are chairs without arm rests available in the adjacent tea-room seating area.
- There are two manual outdoor wheelchairs available for loan. One of the wheelchairs can be self-propelled. The wheelchairs can be booked by phone or email.
- There is no induction loop available at the reception desk.



House

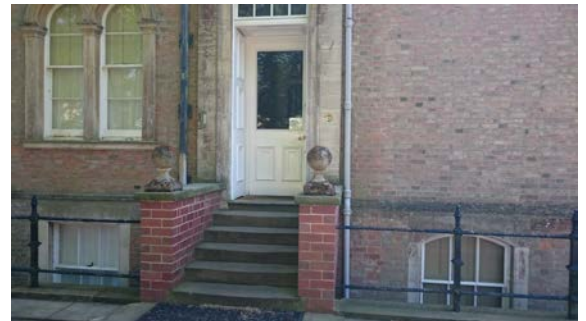

- The blue badge car park is 20 metres from the visitor reception and tea-room, from the tea-room to the house it's 40 metres.
- Paths outside the house consist of flagstones and cobbles (which are slippery after rain). There are some gullies near the entrance which can be a trip hazard.
- There are six stone steps to the entrance door. The door opens inwards and is 850mm wide.
- The alternative entrance is the front door, approx. 25 metres from the side door; along flag stone paths which are uneven. There are ten stone steps to the front entrance.
- The alternative door is 1070mm wide and opens inwards.
- All rooms in the house contain fitted carpets or loose rugs which cover most or all of each floor area. The oak stairs are uncovered timber and this area could be prone to sound echoes.
- There is plenty of natural light throughout the house and there are also pendant lights and table lamps. There is some use of compact fluorescent bulbs in corridors and service areas.
- There are three floors, access to first floor and basement being by stairs only. The stairs have a single handrail each.
- There are no corridors or doorways in the house less than 750mm, with many much wider.
- Most rooms are adequate for turning, except the library. There's a turning space adjacent to the library at the bottom of the oak stairs.
- There are seats in most rooms, without armrests.
- There are volunteer room guides in most rooms on ground floor. There is at least one guide on first floor and one in basement.



National Trust

- There's a unisex toilet in the basement, which is down twelve stone steps and therefore not accessible. There is a more accessible toilet in the courtyard.
- There are no guided tours. The guides don't use induction loops.
- Large print versions of printed text can be made available; please contact us to arrange this facility in advance.
- We accept use of the Gunby wheelchair or wheeled walker only in the house.
- The ground floor office can be used as a quiet room if required.

Gunby Hall - accessible route for wheelchair/walker and avoiding stairs

-  = door needs to be opened
-  = rope barrier needs to be moved
-  = narrow turning point

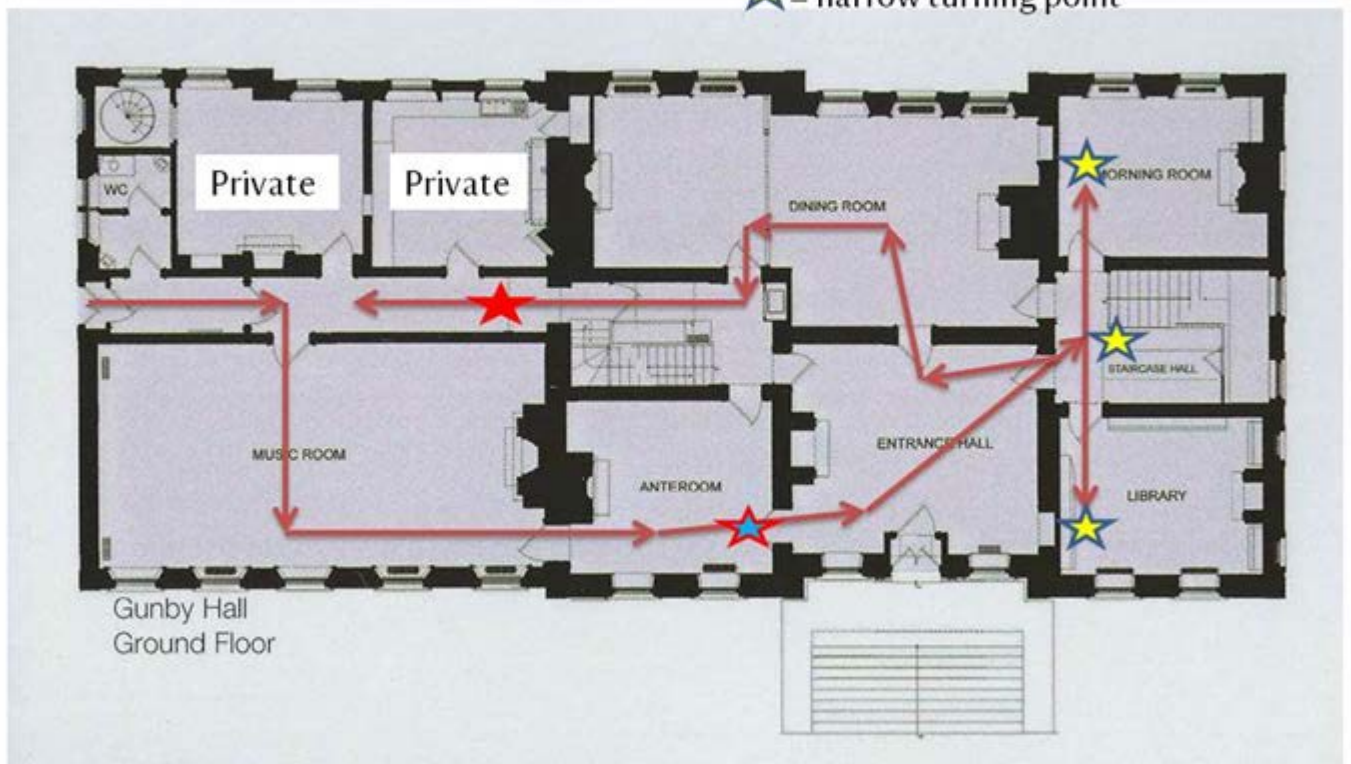

Catering

- It is 20m from the blue badge car park to the tea-room entrance.
- The path to the tea-room consists of tarmac and cobbles. The outdoor seating area is sited on cobbles
- The entrance to the tea-room is 239cm wide and the doors are secured open with hooks during opening hours.
- There is no alternative route into the tea-room.
- There are no soft furnishings in the tea-room.
- The area is lit by natural light and four bare light bulbs.



- There is only one floor in the tea-room. There is a small step into the tea-room (2cm deep).
- There are no corridors. The entrance into the side room of the tea-room is 107cm wide with a step that's 4cm high.
- The counter is 92cm high.
- Staff will assist any visitor needing help in the tea-room.
- There is circulation space of more than 1200mm around the outdoor tables, but only around one table in the indoor seating area of the tea-room. Staff will assist with seating.
- There are no induction loops.
- The menus are not available in Braille, but staff and volunteers will verbally describe what is on offer.
- Straws are available.

Retail – located in the tea-room

- It is 20m from the blue badge car park to the tea-room entrance.
- The path to the tea-room where the retail area is consists of tarmac and cobbles. The outdoor seating is on cobbles.
- The entrance to the tea-room 239cm wide and the doors are secured open with hooks during opening hours.
- There is no alternative route into the tea-room.
- There are no soft furnishings in the tea-room.
- The area is lit by natural light and four bare light bulbs.
- There is only one floor in the tea-room. There is a small step into the tea-room (2cm deep).
- There are no corridors. The entrance into the side room of the tea-room is 107cm wide with a step 4cm high.
- There is a circulation area of 1200mm between the displays stands.
- There are no induction loops.
- Staff will assist visitors in reaching products.
- There is no price list in large print but staff will inform visitors of the prices.

Garden

- There is a map of the garden available (downloadable from the website), it shows only the basic garden path layout, visitor facilities and notable garden features.
- A more level walking or wheeled route around the garden can be achieved by traversing the lawns. There are lowered grass edges to achieve wheeled access onto most lawns. A suggested route is available on request from visitor reception and can be downloaded from the website.
- Many paths in the garden are gravelled. There are large old stone slabs forming the path along the west front of the house. The formal front garden has a slab path with herbs set within. The walled gardens have some paths that have central slabs with gravel each side, historically designed for gardener's wheelbarrows. The north/south path at the east end of the kitchen garden has narrow sections as part of its historic design with rounded clipped box bushes towards its centre and passing the yew hedge at its southern end. The herb garden, as part of its historic design, has grass and narrow stone slab paths with plantings amongst slabs. Likewise, the rose garden has narrow grass paths.

National Trust

- Most paths are reasonably level. However, the east/west centre path in the kitchen garden has a 10% gravelled slope at its western end; a more level entry route is available. There is a 5% slope to the path along the west of the apple store.
- The path along the west front of the house has a low step at the south end; it can be routed around via the lawn. The central entrance to the formal front garden path has two steps, access to this garden area can be achieved via the lawn and entrance into the southern yew hedge lined bowling alley. There is a short steep sloped transition in level from front lawn to the formal garden lawns. There is a sloped bank north and north west of the tennis court as part of its historic design and levelling. Both gateways to the orchard have small steps. Level access to the orchard can be achieved, by prior arrangement, on an otherwise closed route passing by the garden department work base. The entry to the Blue Temple has, within its historic design, a narrow path with one step and then a step into the seating area.
- All garden steps are either single or two steps, with no hand rails
- Most gates are open for access during visitor hours. The gate from the garden to the church path has a hand lifted Suffolk type latch.
- A fold out map is offered at entry along with garden 'work in progress this week' interpretation board. Garden staff and garden guides on peak days, can help and advise.
- There are ten garden benches around the gardens plus the Blue Temple covered seat. Two deck chairs and two director's chairs set on the main lawn in summer months.
- PLEASE BE AWARE: there is a service walkway (like a dry moat) immediately east of the house, it has a brick retaining wall below the sloped western end of the lawn. There is a long canal carp pond at the centre of the garden with paths adjacent on its north and south sides. There are cattle grids immediately each side of the main front entrance gate on the gravelled driveway north- west of the house, this gate is locked closed. There is a cattle grid inside of the clock-tower main entrance gate; there is a pedestrian walkway alongside with handrail.

Gunby Gardens – suggested wheelchair route

 = grass ramp



Grounds/Wider Estate

- The wider estate includes three routes for visitors to take: The Ice House Pond; Bratoft Manor and Monksthorpe Chapel.
- The Ice House Pond walk is 1 mile in length from the house; Bratoft Manor 4 miles; Monksthorpe Chapel: 6-8 miles
- All walking routes involve stiles, apart from the shorter version of the Ice House Pond walk
- All three walks have maps downloadable on the website, with printouts available in the tea rooms.
- Two of our walks: The Ice House Pond and Bratoft Manor are waymarked.
- Cattle are generally present in the parkland and fields from late March until November.
- The Ice House Pond is surrounded by a loose lime stone gravel path.
- Currently, there are no seating areas along our walks.
- The woodland route from the Ice House Pond includes a loose woodchip path, accessible via two steps,
- There are slight gradients on the Ice House Pond path entering from the east field
- There are several gates on every route. Entering into the parkland near St Peters church is a regular clip and latch gate. The Ice House Pond area can be entered and left either through spring gates or stiles. Both short and long walks go through a metal kissing gate on the route back to the house.
- There is a metal kissing gate which is the dividing boundary between the nearest fields to the house.
- The Bratoft Manor site has an interpretation board to the eastern side of its entrance.
- Monksthorpe Chapel has benches to the far side of the graveyard as well as toilet facilities.
- Monksthorpe Chapel is accessible via car.
- Traversing the fields on a wheelchair or electric scooter is not recommended.

Contact details for more information

T: 01754 890102

E: gunbyhall@nationaltrust.org.uk

Date: April 2016